

999 Series

Modular oil
and grease pump



Automatic Lubrication System

999-Modular Pump

USA
GB

Series 999

Modular oil and grease pump

999 Series modular pumps are particularly suitable for the lubrication of small or medium size machinery. They are used for different types of oil and grease lubrication systems and in a very large range of applications because of their high quality, high performance and low cost.

The modular construction of 999 series pumps enables easy dismantling for maintenance, guarantees very high reliability and allows very fast adjustment of the units for different operating conditions.

Steel sheet reservoirs are equipped with low level indicator and electric contact. Reservoirs for oil are equipped with a re-filling filter.



GENERAL FEATURES	
Operating pressure	up 75Mpa (750 bar) (11000 psi)
Fixed Delivery	up to 33 cm ³ /min. 1500 Rpm
Adjustable Delivery	up to 51 cm ³ /min. 2200 Rpm
Lubricant	Oil viscosity 100 cSt min. Grease NLGI 2 (at the operating lubricant temperature between -20° C to + 100° C)

MOTORS	
A.C. Motors	D.C. Motors
Code 3301137 Three phase 220/380V – 50Hz – 0.12kW	Code 3301283 24V 120W
Code 3301269 Single phase 220V – 50Hz – 0.12kW	Code 3301274 12V 100W

Ordering information:

Type of motor and R.P.M.*	Adjustable delivery				Max. Press. bar (psi)	Part No. of Motor Driven Pump 999000 Series Metal Reservoirs Capacity							
	Cm ³ /min		Cu.in./min.			Grease Max. NLGI 3.				Oil Viscosity Min. 15 cSt			
	Min.	Max.	Min.	Max.		3Kg. 6.6lbs.	5Kg. 11lb.	10Kg. 22lb.	30Kg. 66lb.	3 Lt.	5 Lt.	10 Lt.	30 Lt.
A.C. 1500 R.P.M.	1,4	8,5	,08	,6	750 (11000)	999234	999214	999224	999204	999244	999264	999274	999254
	2,5	17	,15	1	400 (5800)	999236	999216	999226	999206	999246	999266	999276	999256
	5	33	,30	2	200 (2900)	999232	999212	999222	999202	999242	999262	999272	999252
A.C. 1500 R.P.M.	Fixed delivery				750 (11000)	999334	999314	999324	999304	999344	999364	999374	999354
	8,5		,6		400 (5800)	999336	999316	999326	999306	999346	999366	999376	999356
	33		2		200 (2900)	999332	999312	999322	999302	999342	999362	999372	999352

R.P.M.* and lubricant deliveries indicated in the table refer to 50Hz. motors. With 60Hz. motors speeds and deliveries are increased by 20%.

Complete pumps:

Pump Assy. Part No.	Adjustable delivery cm ³ /min.	Pressure bar	Grease Reservoir Kg.	Pump Part. no	Kit part no.
999525	2,5 ÷ 17	300 *	30	999206	299462
999510	5,0 ÷ 33	200	5	999212	299474
999527	5,0 ÷ 33	200	10	999222	299474
	Fixed delivery cm ³ /min.				
999506	17	300	30	999306	299462
999533	33	200	10	999322	299474
999540	33	200	30	999302	299474

Overall dimensions:

D i m	Grease Reservoir											
	3 Kg. (6.6 lbs.)				5 Kg. (11 lbs.)				10 Kg. (22 lbs.)		30 Kg. (66 lbs.)	
	Trans.		Metal		Trans.		Metal		mm.	In.	mm.	In.
A	300	11.8	300	11.8	300	11.8	300	11.8	423	16.6	453	17.8
B	332	13.07	468	18.4	392	15.4	528	20.8	623	24.5	803	31.6
CØ	197	7.8	197	7.8	197	7.8	197	7.8	299	11.8	358	14.1

D i m	Oil Reservoir							
	3 litres (.8 US gal.)		5 litres (1.3 US gal.)		10 litres (2.6 US gal.)		30 litres (8 US gal.)	
	mm.	In.	mm.	In.	mm.	In.	mm.	In.
A	300	11.8	300	11.8	423	16.6	453	17.8
B	370	14.5	430	16.9	535	21	692	27.2
CØ	197	7.8	197	7.8	299	11.8	358	14.1

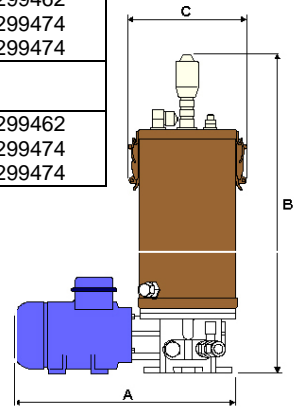

WALL MOUNTING

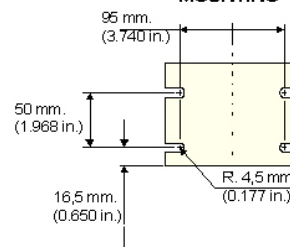

BASE PLATE MOUNTING

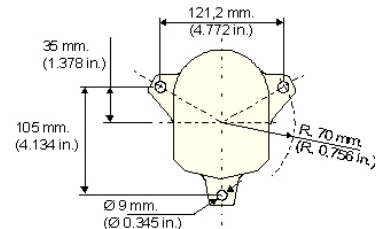

Web site:
<http://www.dropsa.com>

E-mail:
sales@dropsa.com

WK 15/06
C2021PE

ITALY
Dropsa SpA
t.(+39) 02-250791
f.(+39) 02-25079767

SPAIN
Polydrop, S.A.
t.(+34) 93-260-22-50
f.(+34) 93-260-22-51

U.S.A.
Dropsa Corporation
t.(+1) 586-566-1540
f.(+1) 586-566-1541

U.K.
Dropsa (UK) Ltd
t.(+44) 01784-431177
f.(+44) 01784-438598

BRAZIL
Dropsa
t.(+55) 011-563-10007
f.(+55) 011-563-19408

GERMANY
Dropsa GmbH
t.(+49) 0211-394-011
f.(+49) 0211-394-013

AUSTRALIA
Dropsa Australia Ltd.
t.(+61) 02-9938-6644
f.(+61) 02-9938-6611

FRANCE
Dropsa France
t.(+33) 01-3993-0033
f.(+33) 01-3986-2636