



# Fittings & Adaptors ::

SERVICE WITHOUT FRICTION...

## Compression Fittings ::

Male Stud Couplings BSPT ::	
	BSPT
MC104/083 □	4 - 1/8□
MC104/163 □	4 - 1/4□
MC106/083□	6 - 1/8□
MC106/163 □	6 - 1/4□
MC106/243 □	6 - 3/8□
MC110/083 □	10 - 1/8□
MC110/163 □	10 - 1/4□
MC110/243 □	10 - 3/8



Male Stud Elbows BSPT ::	
	BSPT
ME104/083 □	4 - 1/8□
ME106/083 □	6 - 1/8□
ME106/163 □	6 - 1/4□
ME110/163 □	10 - 1/4□
ME110/243 □	10 - 3/8



Equal Ended Couplings ::	
MC104 □	4□
MC106 □	6□
MC110 □	10

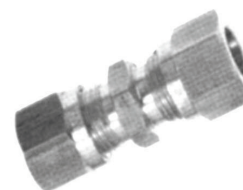

Equal Tees ::	
MT104 □	4□
MT106 □	6□
MT110□	10



Brass Compression Rings - TYPE A ::	
MUR104 □	4□
MUR106 □	6□
MUR110□	10





# Fittings & Adaptors ::

SERVICE WITHOUT FRICTION...

## Battery Plate Adaptors ::

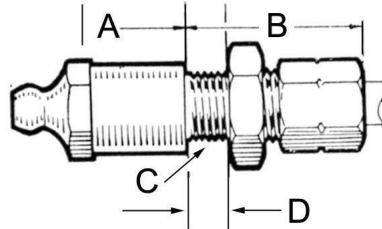

Battery Plate Adaptors ::					
Tube o.d.	Assy. Cat. Number	B	'C' Thd	A	D
3/16"	BPA3/1	25.5	1/8" BSP	13	8
3/16"	BPA3/2	32	1/8" BSP	13	14
1/4" 6mm	BPA4/1 BPA6M/1	32	7/16" X 26	10	12
1/4" 6mm	BPA4/2 BPA6M/2	38	7/16" X 26	10	20
3/8" 10mm	BPA6/1 BPA10M/1	32	9/16" X 20	10	8

\* Please note that the grease nipple is not included



# Fittings & Adaptors ::

SERVICE WITHOUT FRICTION...

## Adaptors ::

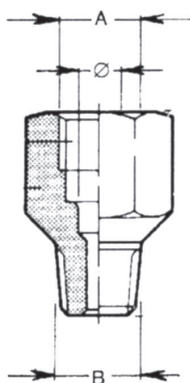

PART NO :: □	A □	B
LV90069 □	M10 X 1 □	M6 X 1 □
50-1101-09 □	5/16 UNF □	1/8 BSPT □
50-1202-03 □	1/8 BSP □	5/16 UNF □
50-1202-02 □	1/8 BSP □	1/4 UNF □
NG6302 □	1/8 BSP □	1/8 BSPT □
NG6303 □	1/8 BSP □	1/8 BSPT

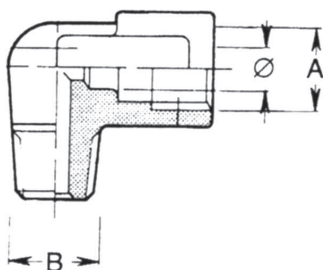

PART NO :: □	A □	B
51-1201-01 □	1/8 BSP □	1/8 BSPT □
51-2001-01 □	5/16 UNF □	1/8 BSPT □
51-1402-03 □	1/8 BSP □	1/4 UNF □
51-1402-02 □	1/8 BSP □	1/8 BSPT

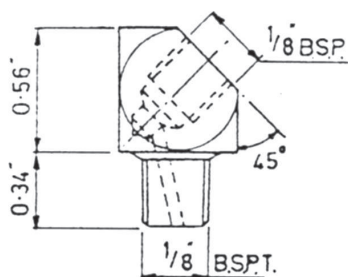

PART NO :: □	A □	B
51-1401-01 □	1/8 BSP □	1/8 BSPT



# Fittings & Adaptors ::

SERVICE WITHOUT FRICTION...

## Anchors ::

TWO WAY WITH SCREWED SPIGOT  
Nº 01-4517

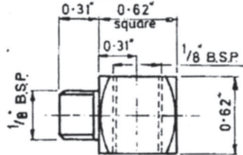

TWO WAY WITH SCREWED SPIGOT  
Nº 01-4518

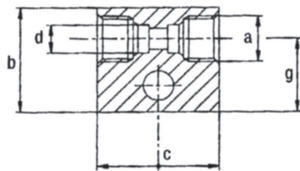
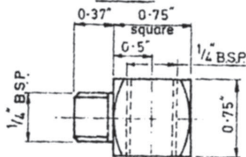

FIVE WAY WITH SCREWED SPIGOT Nº 01-4515

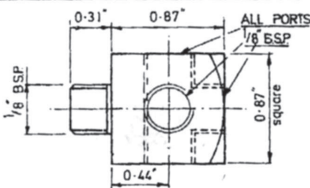

FIVE WAY WITH SCREWED SPIGOT Nº 01-4516

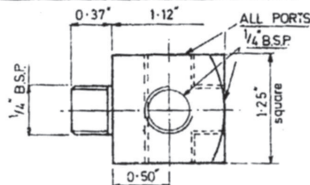

### 2 WAY ANCHORS ::

PART NO	A □	B
01-4517 □	1/8 BSP □	1/8 BSP □
01-4518 □	1/4 BSP □	1/4 BSP

### 2 WAY ANCHORS ::

PART NO	A □	B
118067 □	1/8 BSP □	20mm □
118074 □	1/4 BSP □	30mm

### 5 WAY ANCHORS ::

PART NO	A □	B
01-4515 □	1/8 BSP □	1/8 BSP □
01-4516 □	1/4 BSP □	1/4 BSP



# Fittings & Adaptors ::

SERVICE WITHOUT FRICTION...

## Washers ::

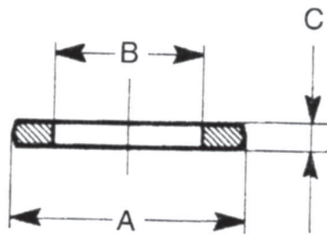

WASHERS ::			
PART NO	A□	B□	C
4301□	15□	10□	Copper□
4323□	18□	13□	Copper□
DS02□	1/8 BSP□		Dowty Seal□
DS04□	1/4 BSP□		Dowty Seal□
DS06□	3/8 BSP□		Dowty Seal

## Blanking Plug ::

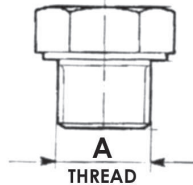

BLANKING PLUG ::			
PART NO	A□	B□	C
100727□	1/8 BSPT□	-□	-□
102017□	1/4 BSP□	-□	-

## Reducing Bush ::



REDUCING BUSH ::			
PART NO	A□	B□	C
28113□	1/8 BSP□	1/8 BSP□	-□
RB0204□	1/8 BSP□	1/4 BSPT□	-□
RB0406□	1/4 BSP□	3/8 BSPT□	-

## Rotary Coupling ::

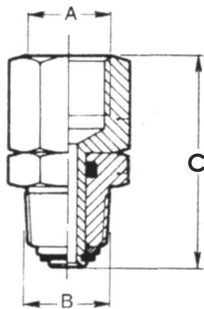

ROTARY COUPLING ::			
PART NO	A□	B□	C
936500□	1/8 BSP□	1/8 BSP□	500□
936200□	1/4 BSP□	1/4 BSP□	500□
1168000□	1/8 BSP□	1/8 BSP□	100□
52938□	1/8 NPT□	1/8 NPT□	100□
52938/101□	1/8 BSP□	1/8 BSP□	100□
936035□	1/8 BSP□	1/8 BSP□	1500

## Hexagonal Socket ::



HEXAGONAL SOCKET ::			
PART NO	A□	B□	C
CL29/B□	1/8 BSP□	-□	Brass□
CL29/S□	1/8 BSP□	-□	Brass□
HS02□	1/8 BSP□	-□	Steel□
HS04□	1/4 BSP□	-□	Steel



# Fittings & Adaptors ::

SERVICE WITHOUT FRICTION...

## Relief Valve ::

Spring loaded relief valves, primarily for use with oil. Consisting of brass body '92s and steel spring they are threaded 1/8 BSP

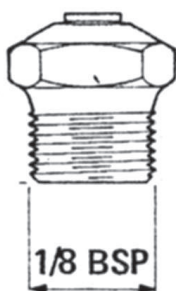

PART NO ::□	RELIEF PRESSURE ::
Z573/1□	45-80 lbf/in <sub>2</sub> □
7573/3□	8-15 lbf/in <sub>2</sub> □
7573/5□	1 - 5 lbf/in <sub>2</sub>

## Air Pressure Relief Valve ::

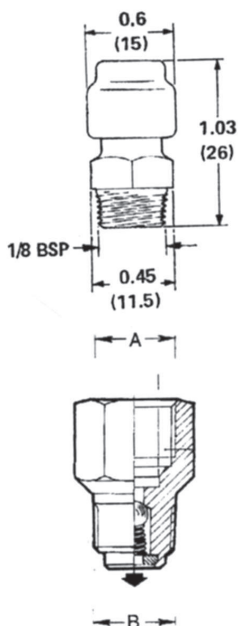

Designed to relieve air pressure building up in gearboxes as a result of temperature rise, this valve is screwed into the top of the gearbox casing, above the oil level. Consisting of a brass body and cap which house a spring and rubber valve disc, it opens at a pressure of 1-3 lbf/in<sub>2</sub> (0.07 - 0.2kgf/cm<sub>2</sub>)

Part No: OA 6862

NON - RETURN VALVE ::		
PART NO	A □	B
LV90845□	1/8 BSP□	1/8 BSP□
LV90173□	1/4 BSP□	1/4 BSP

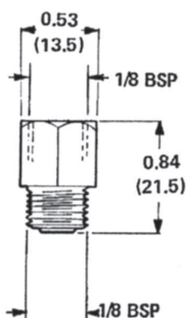

NON - RETURN VALVE ::		
PART NO	A □	B
*5383/1□	1/8 BSP □	1/8 BSP

\* Phosphor bronze back and spring